

Chambre #3  
10'-8" x 12'-0"

Chambre #2  
11'-0" x 12'-0"

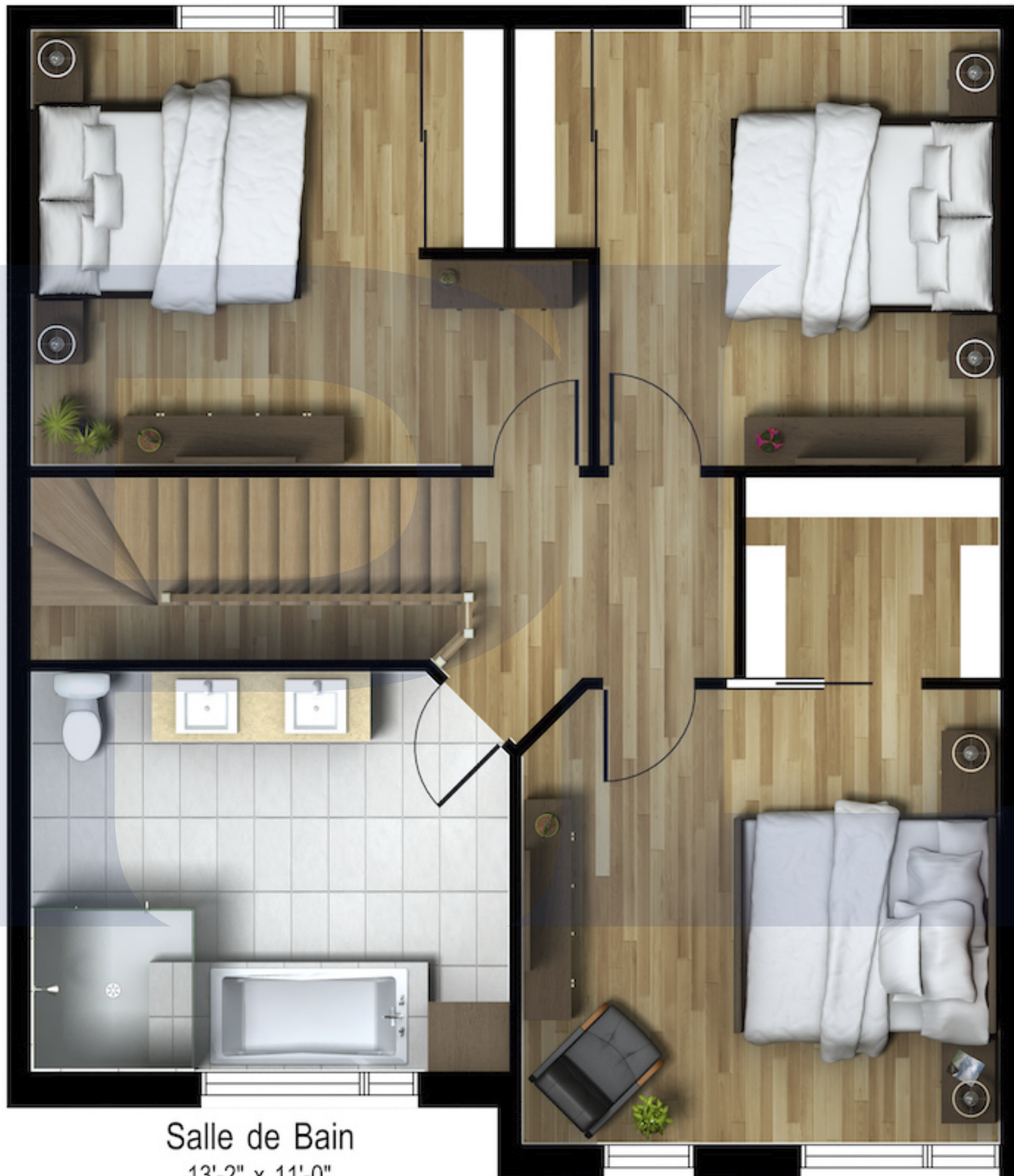

Salle de Bain  
13'-2" x 11'-0"

Walk-In  
7'-0" x 5'-6"

Chambre Principale  
13'-2" x 12'-6"

Cuisine  
11'-4" x 12'-0"

Salle à Manger  
15'-4" x 12'-0"



Foyer au Gaz

3'-4" x 8'-0"

3'-9" x 5'-0"

Hall d'entrée  
9'-0" x 5'-0"

Salon  
13'-2" x 19'-0"